

# Example Application – Ramp Modification

Client name:

Client contact number:

Client address:

Funding body:

Occupational Therapist:

OT contact number:

OT email:

SKETCH (not to scale) HM 09 1/17

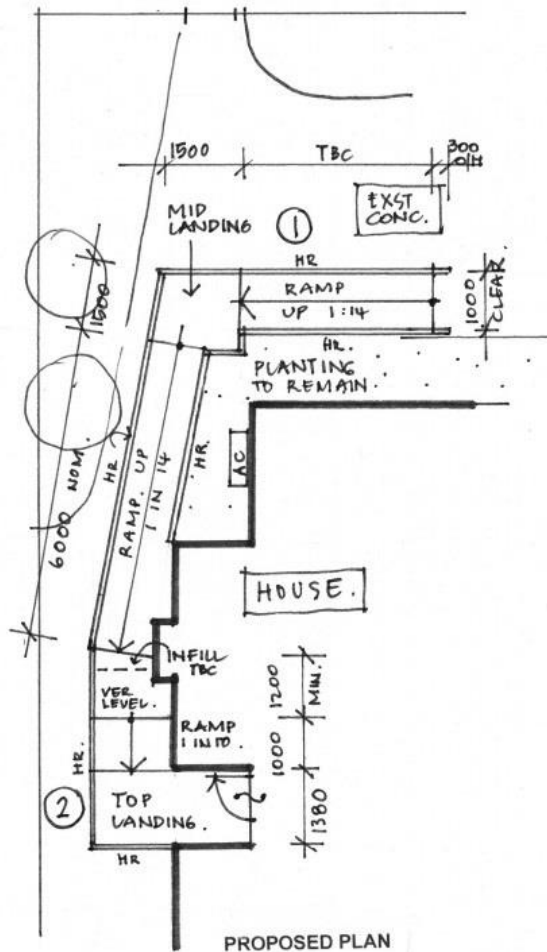
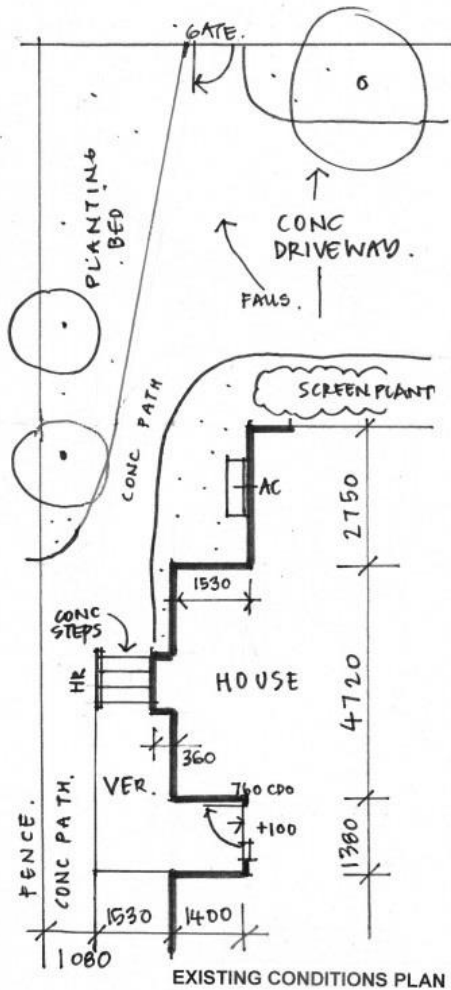

**SCOPE OF WORKS – TIMBER RAMP**  
 BUILDER MUST VISIT SITE WHEN QUOTING AND CONFIRM ALL DIMENSIONS AND CONDITIONS PRIOR TO COMMENCEMENT OF ANY WORKS. NOTIFY O.T OR ARCHITECT OF ANY DISCREPANCIES OR CHANGES.

ALL WORK TO COMPLY WITH BCA AND A.S 1428.1 (WHERE APPLICABLE)

CLEAR ALL AREA AS REQUIRED FOR NEW RAMP.

CUT BACK OR REMOVE SHRUBS AS REQ'D.

BUILD NEW TOP LANDING TO BE LEVEL WITH DOOR SILL.

BUILD NEW TIMBER RAMPS AS DRAWN. BUILD OVER EXST VERANDAH AND CONC DRIVE. INSTALL NEW 30 -50 DIA. HANDRAILS AND KERBS TO RAMP.

NOTE ANGLE RAMP AS REQ'D. CONFIRM ON SITE REFER TO STANDARD RAMP DETAIL. INSTALL DECKING REEDED SIDE DOWN AND ALUM PLATE AT THE COMMENCEMENT OF THE RAMPS AS PER DETAIL.

CONFIRM HAND RAIL HEIGHTS/MID RAIL WITH O.T AND CLIENT PRIOR TO INSTALLATION.

INSTALL A MAGNETIC DOOR STOP TO SCREEN DOOR.

CLEAR AWAY ALL RUBBISH ON COMPLETION.

HEIGHT (TBC)	
RAMP 1	710mm APPROX.
RAMP 2	100 mm APPROX
LENGTH	
RAMP 1	9940 mm APPROX.
RAMP 2	1000 mm APPROX.
MIN. GRADIENT	
RAMP 1	1 IN 14
RAMP 2	1 IN 10
MIN. WIDTH BETWEEN RAILS	1000 mm APPROX.
MIN. HANDRAIL CLEARANCE FROM ALL OBSTRUCTIONS	50 mm

**PHOTOS**

